

ASSEMBLY

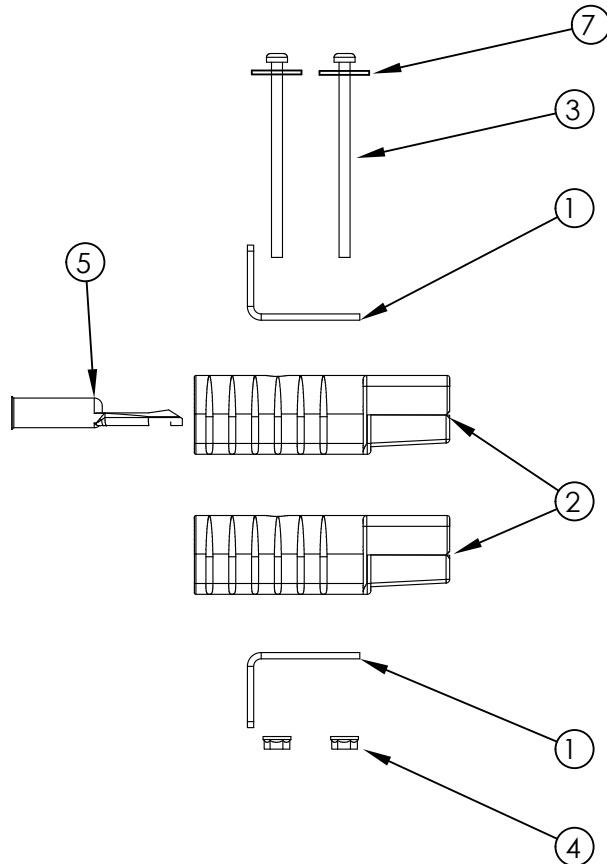

ITEM	PART NUMBER	DESCRIPTION	QTY
1	300118-1	HANDLE	2
2	EE2327	ANDERSON POWER PRODUCTS HOUSING	2
3	20583-000	RHMS, 1/4-20 X 2.50	2
4	16248-000	FLANGE NUT, 1/4-20	2
5	EE23281	#2 WIRE CONTACT	4
6	EE23282	#4 WIRE CONTACT	4
7	512-000	FLAT WASHER, 1/4	2

REVISIONS					
REV.	IRN	DESCRIPTION	DATE	BY	APP'D
B	2588	UPDATED BOM	3/19/2014	PJY	DRC
C	3885	ADDED WASHERS TO MATCH BOLT AND WASHER STANDARD	6/12/15	PJY	DRC
D	4802	UPDATED NOTES, PART NUMBERS, TABLE A - SEE IRN	2/4/2016	ZJF	ZJF
E	5644	ADDED WIRE TYPE NOTE	7/29/2016	SJM	ZJF
F	P305	ADDED INFO FOR 1PH 30PTO	1/16/2019	IDS	DRD

TABLE (A) LEADWIRE RECOMMENDATIONS		
MODEL	SIZE (AWG) / INSULATION	CONTACTS
30PTOC/T-03 (120/240V)	#4 (THW)	EE23282 *

APPROVED CRIMPING TOOLS

1. ANDERSON POWER PRODUCTS
2. ETC MODEL HHS HYDRAULIC CRIMPER
3. IIT BLACKBURN #1640
4. THOMAS & BETTS #TBMS

* REFER TO TABLE 310 (NATIONAL ELECTRIC CODE) FOR OTHER TYPES OF WIRE BEING USED.

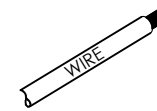
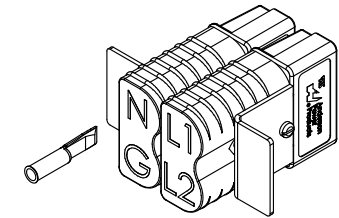

1. READ INSTRUCTIONS IN FULL PRIOR TO ASSEMBLING PLUG KIT
2. VERIFY THAT ALL ITEMS AND CORRECT QUANTITIES ARE IN THE PACKAGE
3. INSTALL CONTACTS (WITH BUSHINGS IF APPLICABLE) ON ELECTRICAL CONDUCTOR (SEE TABLE "A") BY SOLDERING, USING A GOOD GRADE OF RESIN CORE SOLDER OR AN APPROPRIATE COMPRESSION CRIMPER AS RECOMMENDED BY WINCO INC. (WARNING: SOLDER ONLY COPPER CONDUCTORS, DO NOT USE ACID CORE SOLDER!)
4. ASSEMBLE ITEMS ACCORDING TO THE EXPLODED VIEW AT THE LEFT SIDE OF PAGE
5. INSERT THE CONDUCTORS (WITH CONTACTS INSTALLED) INTO THE PROPER CAVITIES AS SHOWN ABOVE. CONNECTOR MUST SNAP INTO HOUSING, PULL ON WIRE TO ENSURE A POSITIVE LOCK. EMPTY CAVITY MUST HAVE A DUMMY CONTACT INSERTED.

NOTE: IF LARGER CONTACTS ARE NEEDED FOR YOUR APPLICATION, PLEASE CONTACT WINCO AT PH: 507-357-6831